

Courses & Distances
Down Little Juniatta
from a Post
Perches

S 87 8 20
N 73 8 78
S 80 8 20
S 50 8 12
S 27 8 52 to a pine
182

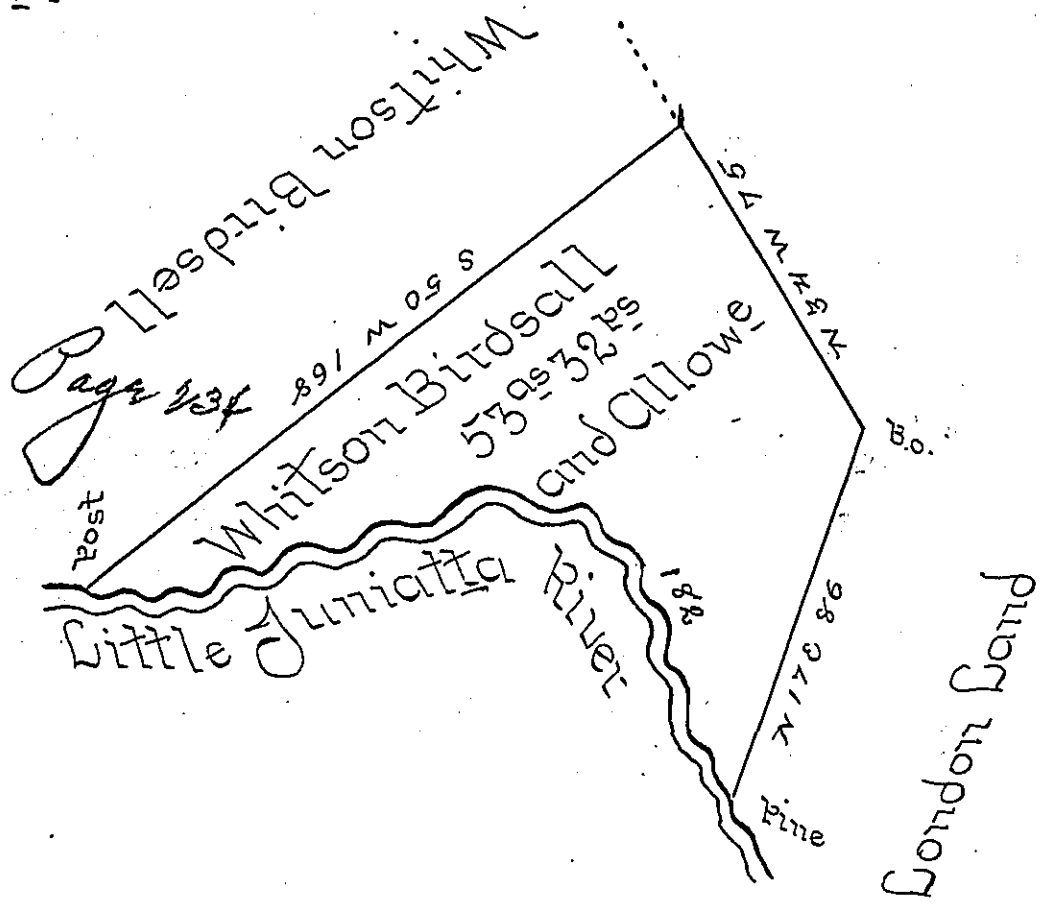

Situate in Warrior Mark Township Huntingdon County
Containing Fifty three Acres Thirty two Perches and the usual
Allowance for Roads &c. Surveyed the 24th Day of August 1802
in Pursuance of a Warrant dated the 20th of March 1794

John Canan U.S.

Samuel Cochran Esquire Sr.

IN TESTIMONY that the above is a copy of the original remaining on file in
the Department of Internal Affairs of Pennsylvania, made
conformably to an Act of Assembly approved the 16th day of
February, 1833, I have hereunto set my Hand and caused
the Seal of said Department to be affixed at Harrisburg,
this Third day of April 1900.

James W. Latta
Secretary of Internal Affairs.